



DOG ON IT PARKS

DOG-ON-IT-PARKS.COM

This space-saving fountain offers the flexibility of either mounting to a wall or onto a concrete pad as a free standing unit. The fountain is activated by a side mounted, self-closing button and once filled, the slow drain feature allows the dog to quench its thirst for 30-60 seconds before draining to help prevent unsafe standing water. Unit adheres to NSF/ANSI 61, Section 9, Public Law 111-380 (No Lead) and CHSC 116875. Also features optional freeze resistant valves and/or a remote push button on a wall mounted plate.



Views:

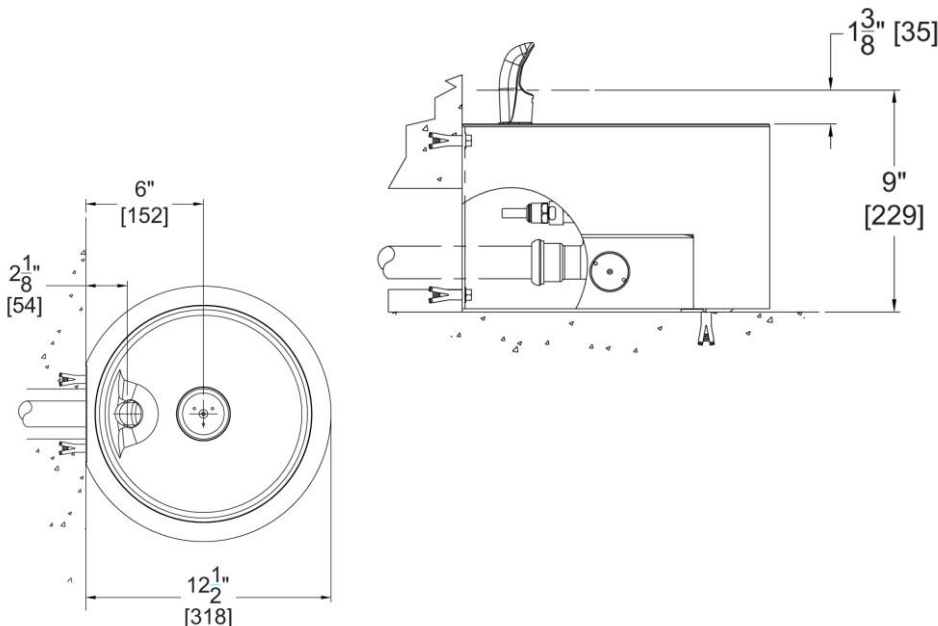

7216 PET FOUNTAIN

**18 gauge, 304
stainless steel bowl
with 12 gauge
stainless steel
receptor**

**15 powder coat
color options
available**

**Operates on water
pressure range of
20-105 psig**

DOG-ON-IT-PARKS

4818 Evergreen Way
Ste 250
Everett, WA 98203
P: 877-348-3647

www.dog-on-it-parks.com

Refer to installation manual for
more detailed specifications

Copyright 2016

